

# Criss cross beams

by SUPAWOOD

Our MAXI BEAM and ALUCLICK beam products are perfect for creating dynamic criss cross beam configurations on both ceilings and walls.

Criss cross beams are available in standard or custom configurations, acoustic options and a huge range of finishes. All this makes them perfect for endless applications.



Huge range of design options • Fire Group 2 available • Engineering details

[SUPAWOOD.COM.AU](http://SUPAWOOD.COM.AU)

**SUPAWOOD**  
ARCHITECTURAL LINING SYSTEMS



# Frequently Asked Questions

| Special Applications:             |   |
|-----------------------------------|---|
| Fire Group and Finishes available | Fire Group 2 – Supasurface V-Series, Supafinish, Supacolour<br>Fire Group 3 – Supaveneer, Supalami  |
| Sustainability                    | Formaldehyde E0 (E1 if Fire Group 2).<br>FSC or PEFC available in all finishes except some veneers. |
| Humid areas                       | Aluminium with woodgrain versions available.  |
| Panel Dimensions:                 |   |
| Blade depth                       | Up to 600mm.  |
| Installation:                     |   |
| Fixing centres                    | See span table.   |
| Services, positioning             | Usually positioned between beams.<br>LED lights can also be supplied set into the bottom of a beam. |
| Services, maximum weight          | See span table for weight limitations for services and hanging decorations.                         |
| Seismic Engineering               | Available on request.   |

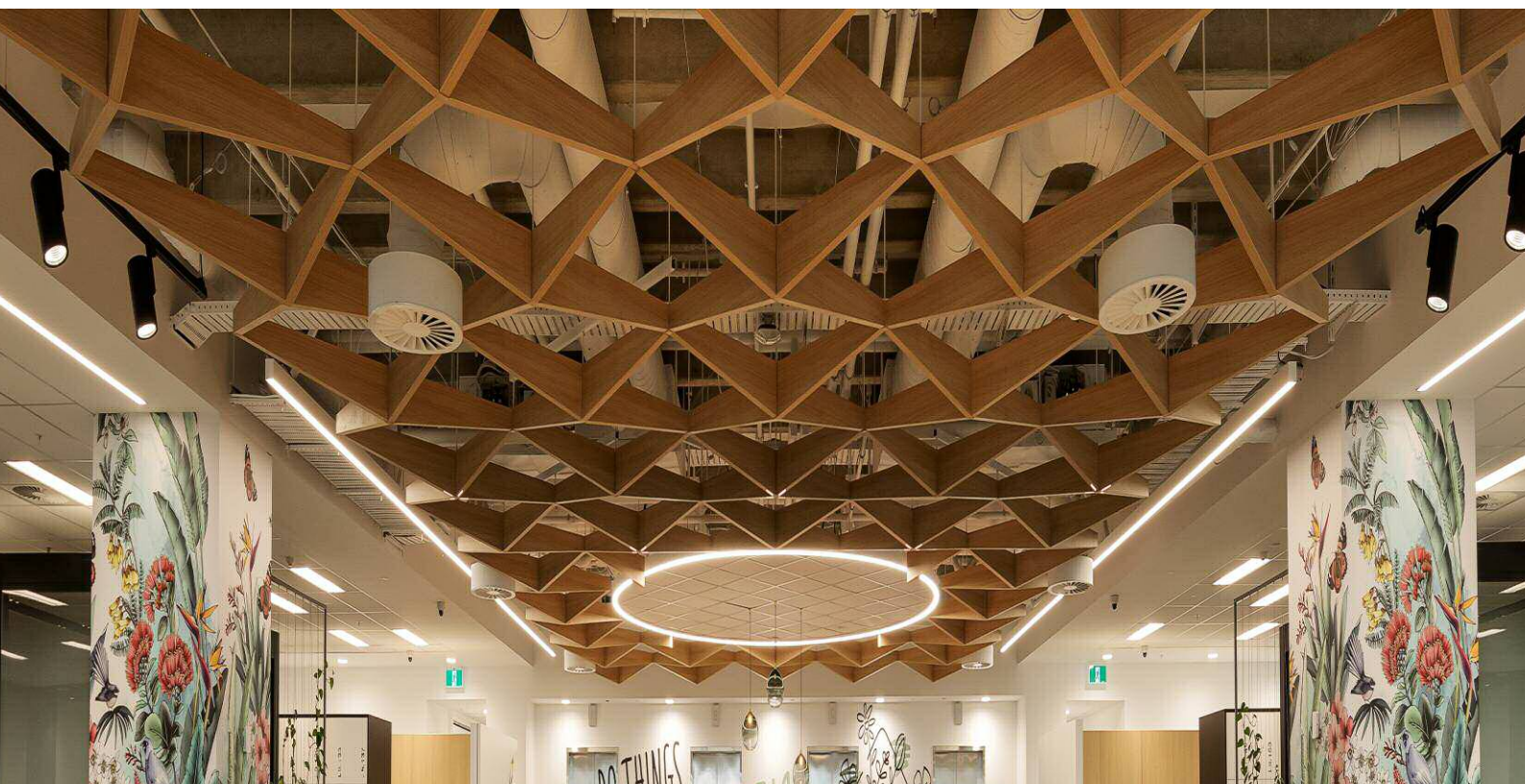

## CRISS CROSS BEAM FIXING

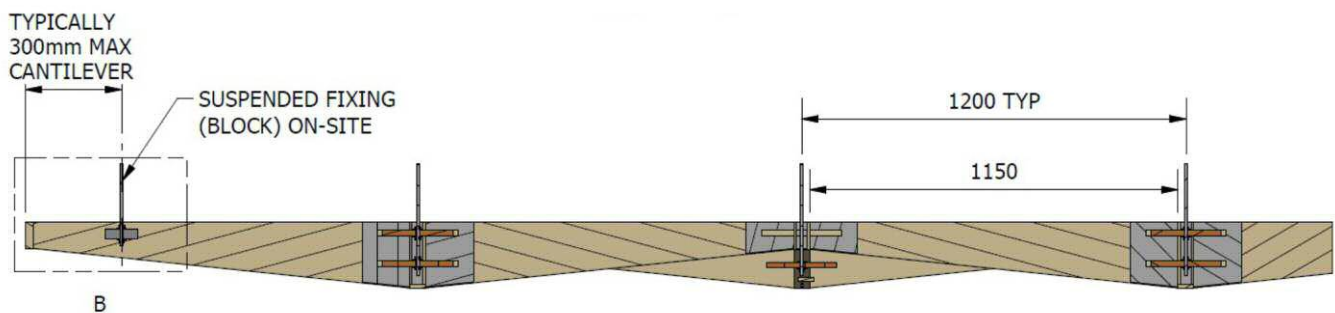

FIXING DETAIL AND SUSPENSION DETAIL

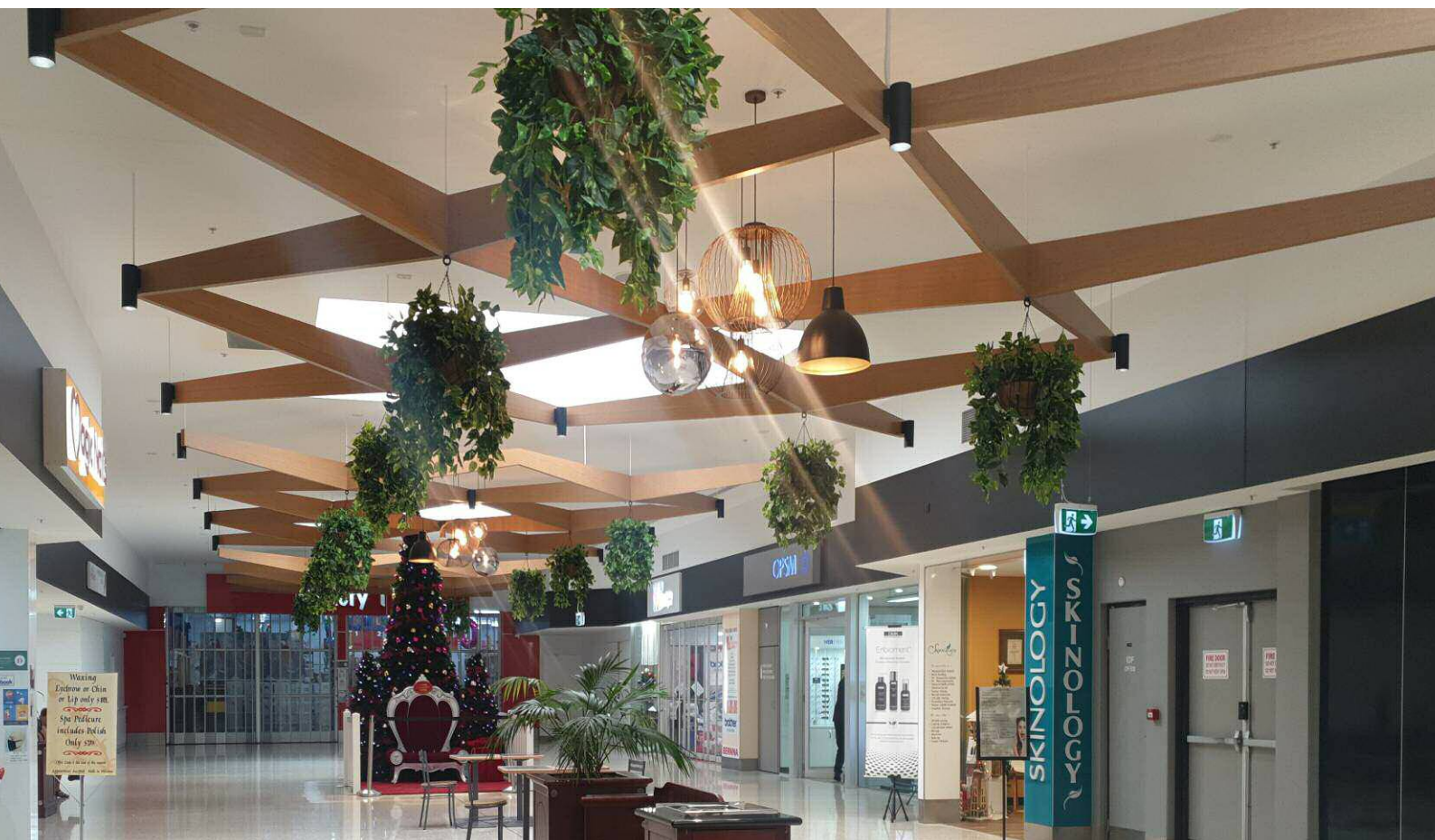
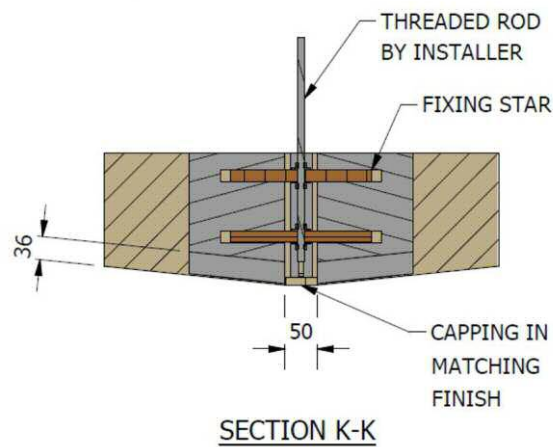



## FIXING STARS, EXAMPLES

Typical plan detail

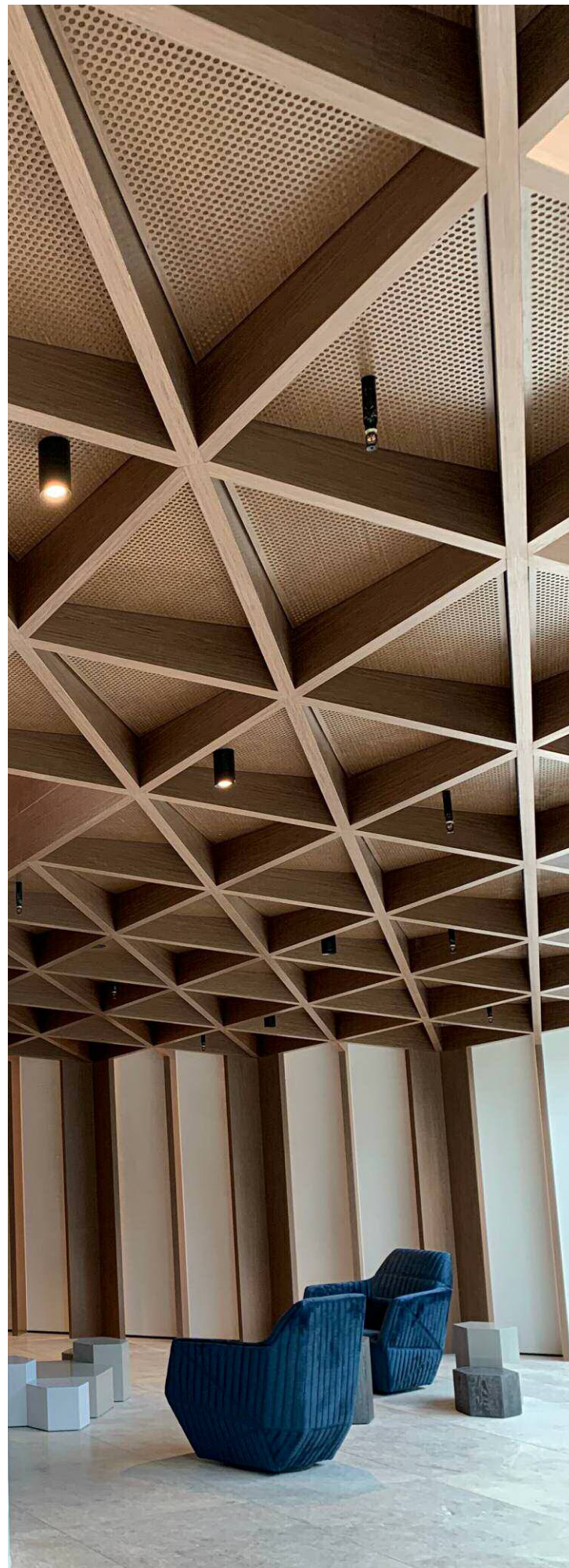
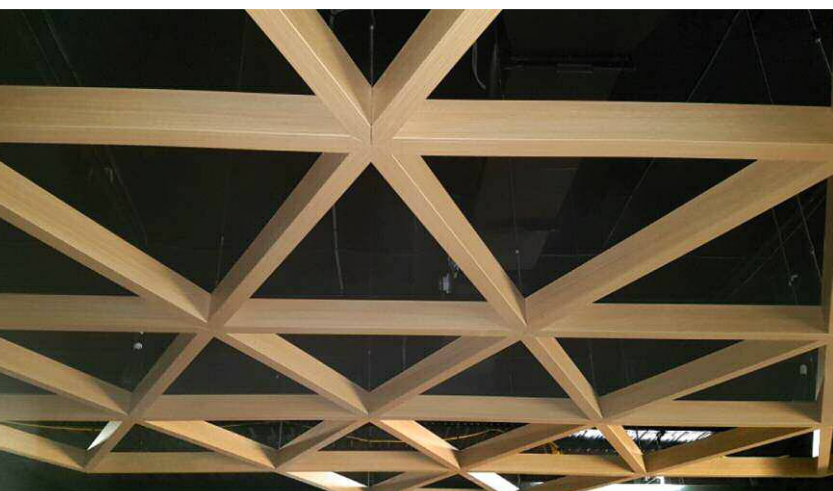
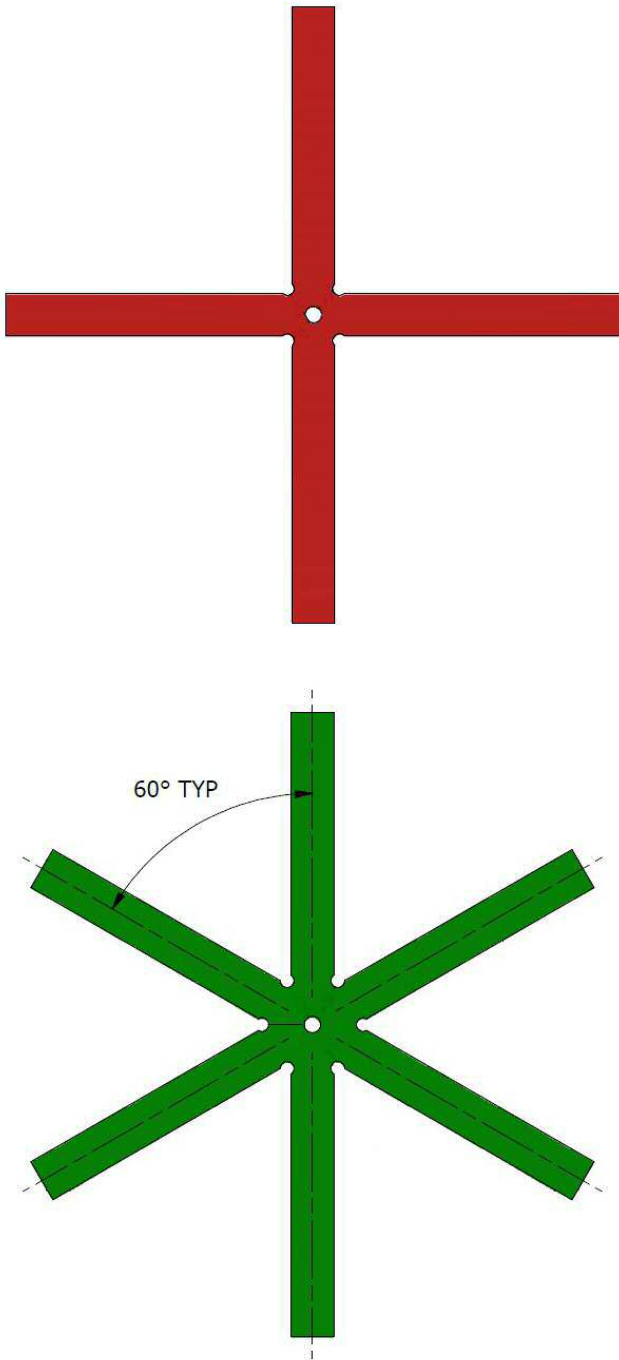



## ANGLED BEAM CONNECTION

ISOMETRIC VIEW

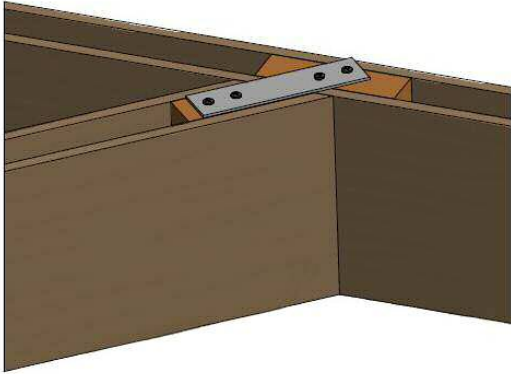

PLAN

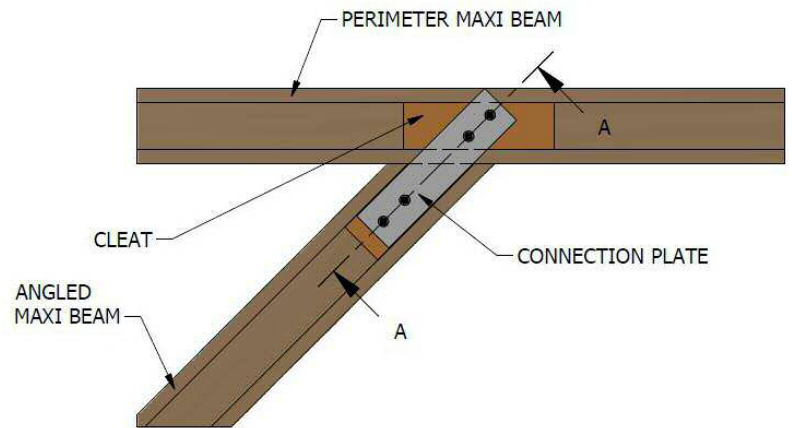

## LED LIGHTING

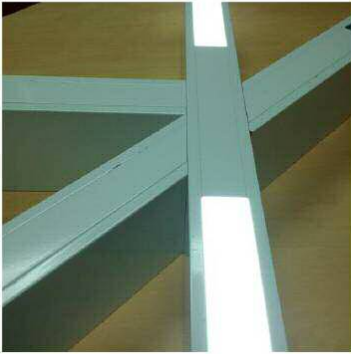

ALUCLICK ANGLED

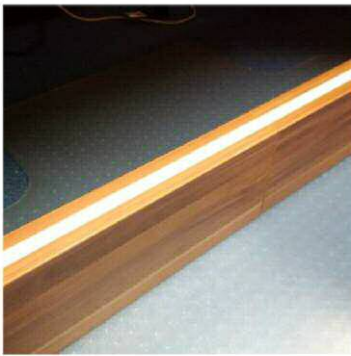

LIGHT OFF



LIGHT ON

END CAP FIXED  
WHERE REQUIRED

BEAM EDGE

LED LIGHT INSERT  
BY OTHERS

© SUPAWOOD - Drawing #3071

Led width: 17 - 24mm

Led lumen: 500 - 2100 lumens/metre

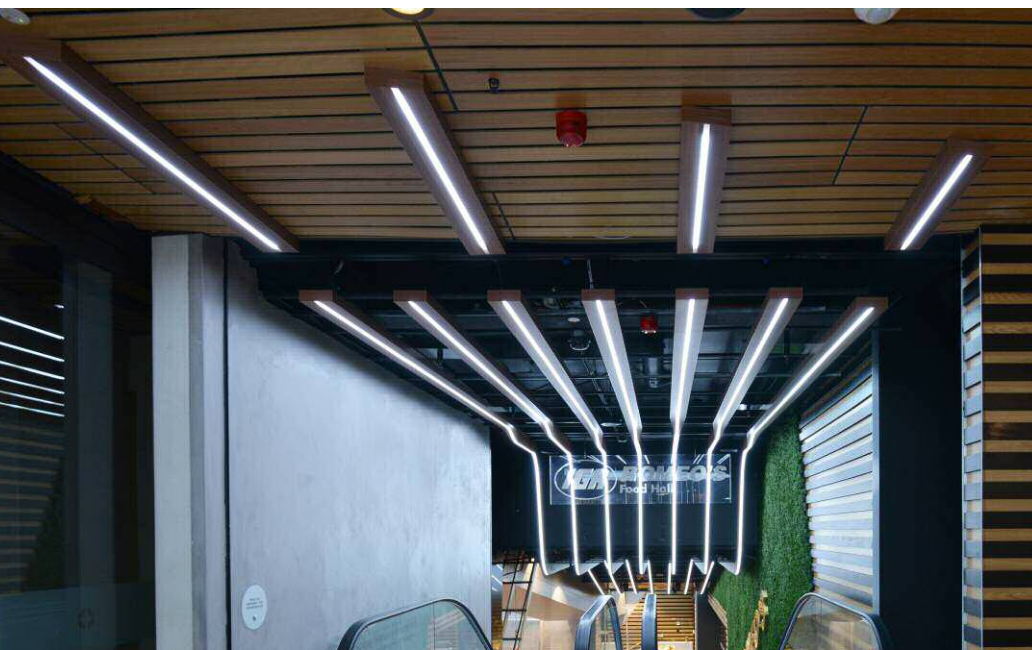



# MAXI BEAM & ALUCLICK Technical Data

## Beam Weights

| Special Applications:<br>(all 50mm thick) | Supalami<br>Supacolour<br>(non FR)<br>All 8mm skins | Supafinish<br>Supaveneer<br>Supacolour FR<br>Supasurface V-Series<br>All 9mm skins | Aluclick    |
|---|---|--|-------------|
| Weight per m <sup>2</sup> of board        | 13.36 kg/m <sup>2</sup>                             | Approx. 17.5 kg/m <sup>2</sup>   |             |
| Aluclick/ Maxi Beam nom. 100mm            | 1.34 kg/LM  | Approx. 2.2 kg/ LM   | 1.77 kg/ LM |
| Aluclick/ Maxi Beam nom. 150mm            | 2.00 kg/LM  | Approx. 2.6 kg/ LM   | 2.86 kg/ LM |
| Maxi Beam nom. 200mm                      | 2.67 kg/LM  | Approx. 3.9 kg/ LM   |             |
| Maxi Beam nom. 300mm                      | 4.01 kg/LM  | Approx. 5.7 kg/ LM   |             |
| Aluclick capping                          |   |  | 0.30 kg/ LM |

## Span Limits

| Beam type   | Maximum span | Weight loading to centre of span | Deflection at centre | Maximum cantelver |
|---|--------------|----------------------------------|----------------------|-------------------|
| Supalami or Supacolour (non FR)<br>All 8mm skins, 200mm high                        | 1800mm       | 5kg                              | 1mm                  | 900mm             |
|   | 1800mm       | 30kg                             | 2mm                  | 900mm             |
| Supafinish or<br>Supasurface V-Series<br>Supacolour FR<br>All 9mm skins, 200mm high | 1800mm       | 10kg                             | 1mm                  | 900mm             |
|   | 1800mm       | 40kg                             | 2mm                  | 900mm             |
|   | 2400mm       | 2.5kg                            | 1mm                  | 900mm             |
|   | 2400mm       | 10kg                             | 2mm                  | 900mm             |
| Supaveneer<br>All 9mm skins, 200mm high   | 2400mm       | 5kg                              | 1mm                  | 900mm             |
|   | 2400mm       | 10kg                             | 2mm                  | 900mm             |
| Aluclick 100mm high   | 3000mm       | 10kg                             | 1.5mm                | 1500mm            |
|   | 3000mm       | 20kg                             | 3mm                  | 1500mm            |
|   | 6000mm       | 2.5kg                            | 3mm                  | 1500mm            |
|   | 6000mm       | 5kg                              | 6mm                  | 1500mm            |
| Aluclick 150mm high   | 3000mm       | 40kg                             | 1mm                  | 1500mm            |
|   | 3000mm       | 65kg                             | 2mm                  | 1500mm            |
|   | 6000mm       | 20kg                             | 2mm                  | 1500mm            |
|   | 6000mm       | 40kg                             | 5mm                  | 1500mm            |

Deflections below are short term deflections based on ceiling install. Double these to get approximate long-term deflections. Note when installed vertically indoors, spans and cantilever distances can be doubled. These span limits are based on interior use.

*Datasheet updated 14/7/21*



**SUPAWOOD**  
ARCHITECTURAL LINING SYSTEMS

**SUPAWOOD HEAD OFFICE**

Australasian Support & Manufacturing

Aus: +61 1800 002 123

NZ: +64 (0) 9887 3234

[info@supawood.com.au](mailto:info@supawood.com.au)

[SUPAWOOD.COM.AU](http://SUPAWOOD.COM.AU)

As **adaptable** as your *imagination* ...